

Standard Console Configurations

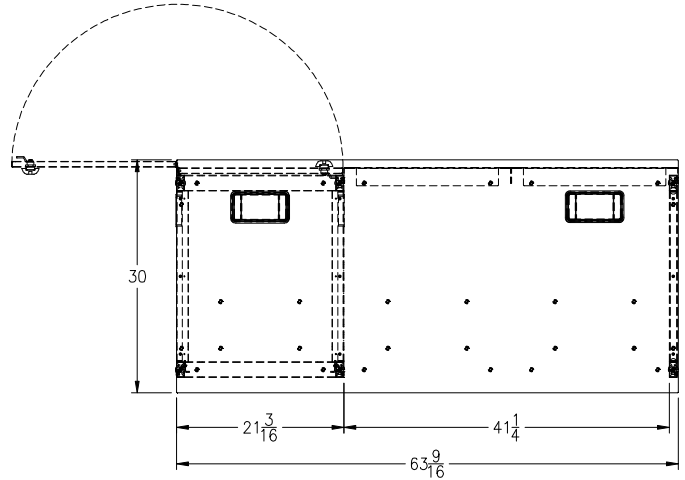

Console #1 (29"H) - 68020		
Qty	Description	Item#
1	Triple Worksurface	68202
1	29" Equipment Rack	68107
2	29" Wall Filler Panel	68101
1	29" End-Support Leg	68105

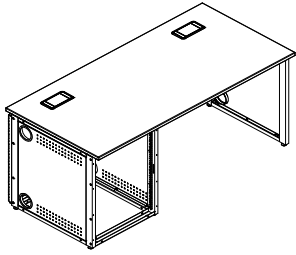
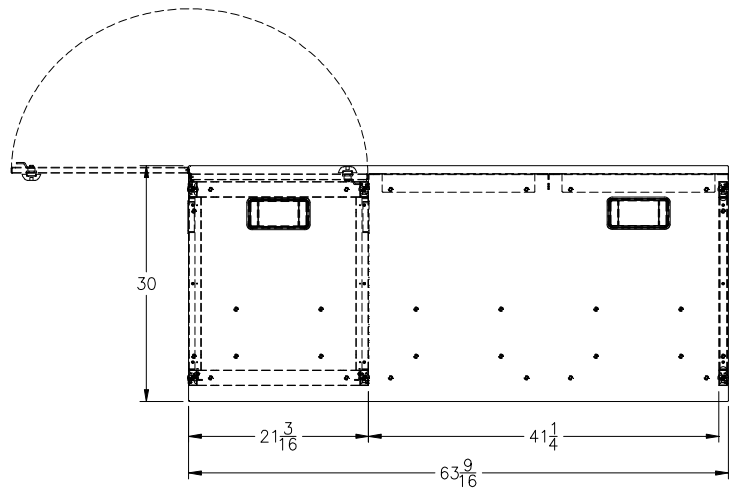
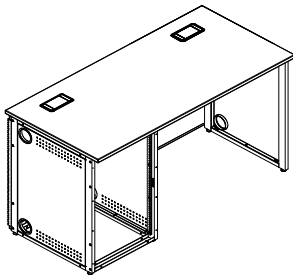
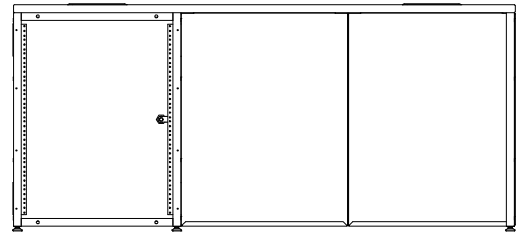
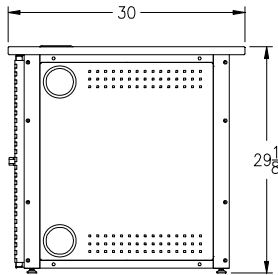

Console #1 (36"H) - 68021		
Qty	Description	Item#
1	Triple Worksurface	68202
1	36" Equipment Rack	68157
2	36" Wall Filler Panel	68151
1	36" End-Support Leg	68155

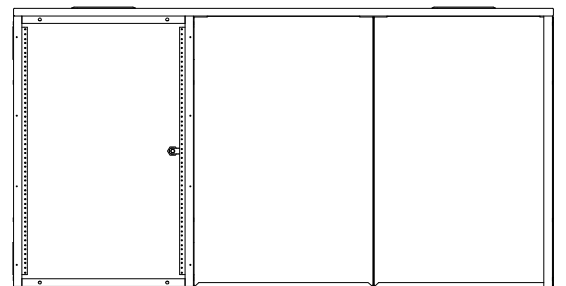
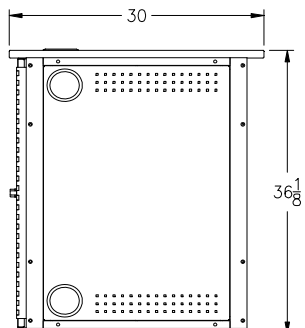

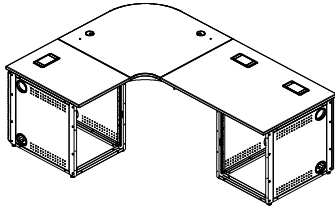

Console #2 (29"H) - 68022		
Qty	Description	Item#
1	29" Radius Corner	68106
1	Double Worksurface	68201
1	Single Worksurface	68200
2	29" Equipment Rack	68107
1	29" Wall Filler Panel	68101

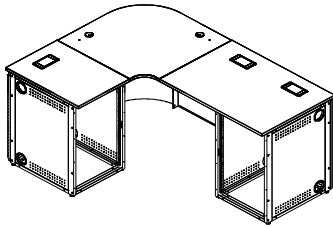
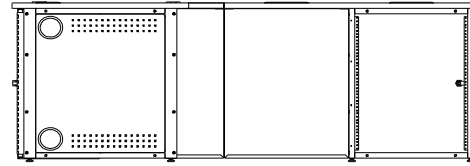
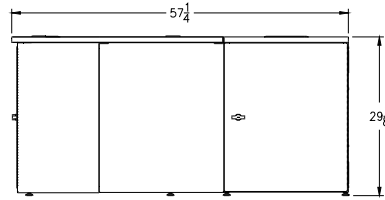
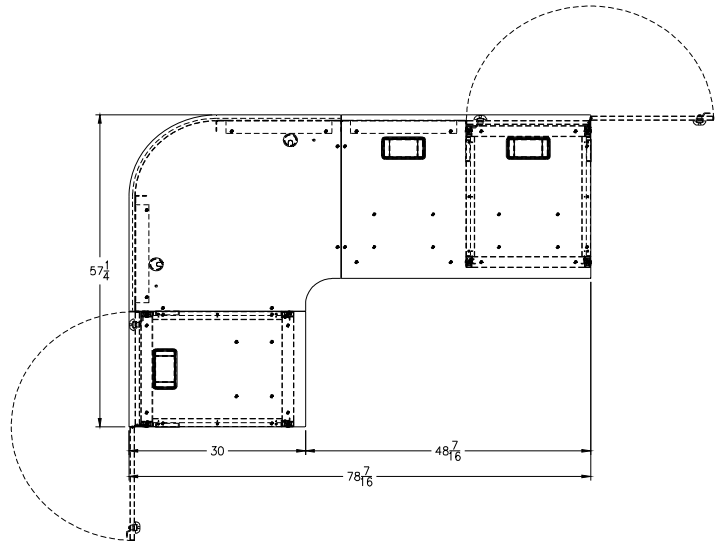

Console #2 (36"H) - 68023		
Qty	Description	Item#
1	36" Radius Corner	68156
1	Double Worksurface	68201
1	Single Worksurface	68200
2	36" Equipment Rack	68157
1	36" Wall Filler Panel	68151

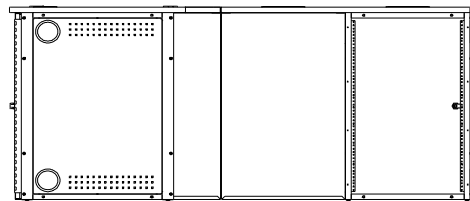
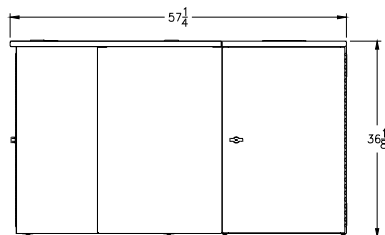
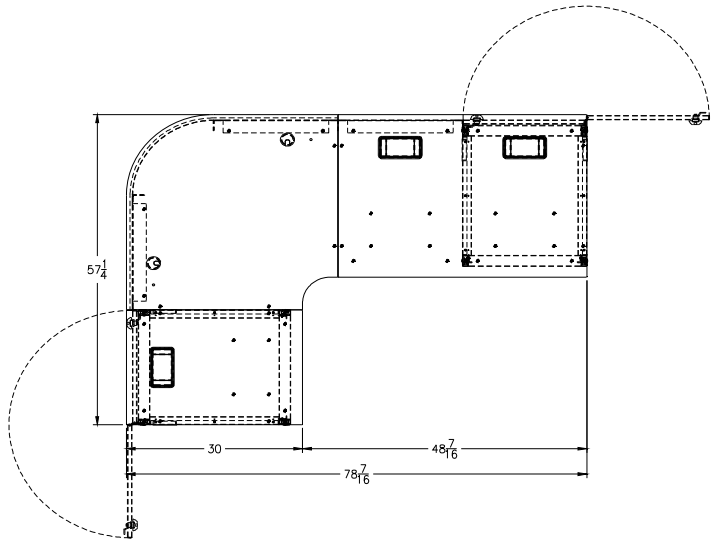

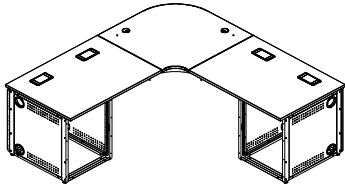

Console #3 (29"H) - 68024		
Qty	Description	Item#
1	29" Radius Corner	68106
2	Double Worksurface	68201
2	29" Equipment Rack	68107
2	29" Wall Filler Panel	68101

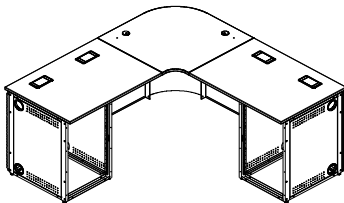
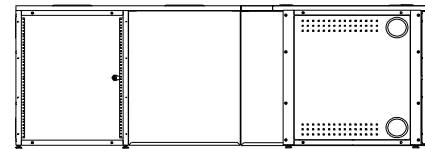
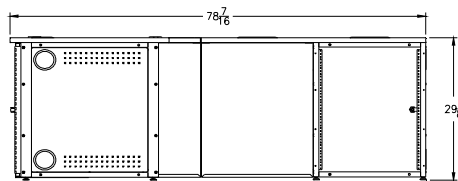
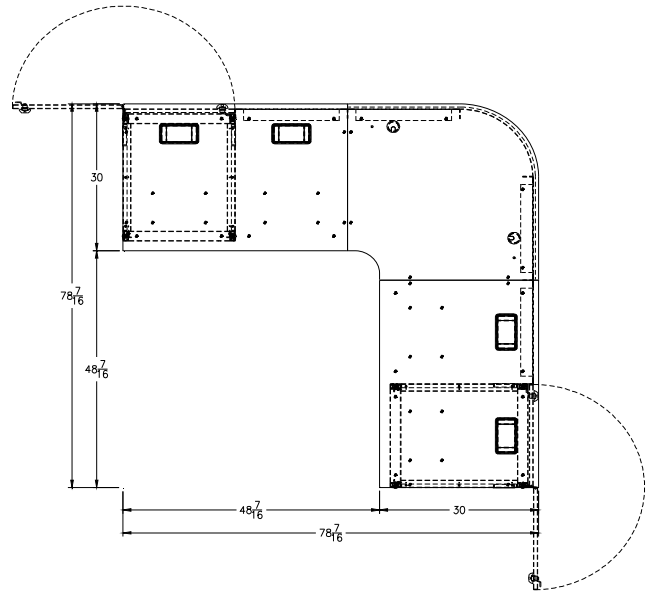

Console #3 (36"H) - 68025		
Qty	Description	Item#
1	36" Radius Corner	68156
2	Double Worksurface	68201
2	36" Equipment Rack	68157
2	36" Wall Filler Panel	68151

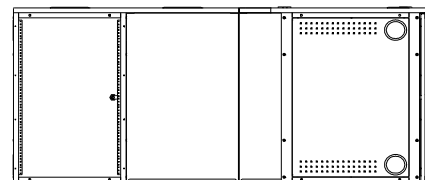
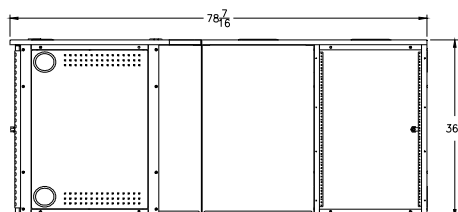
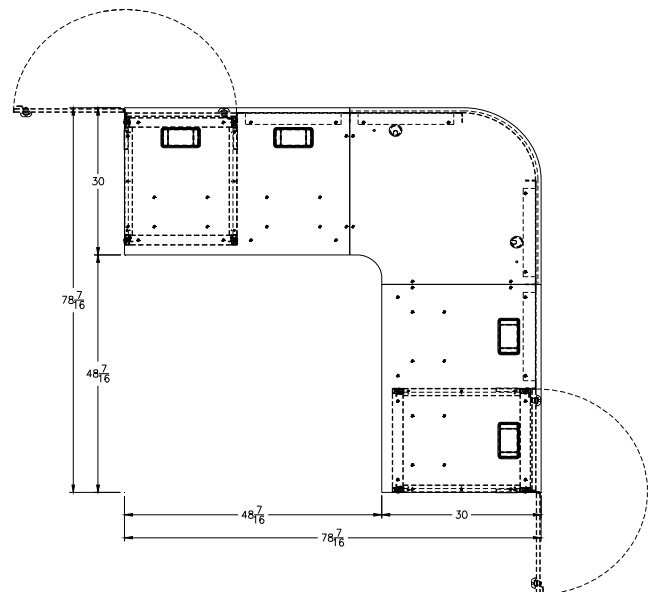

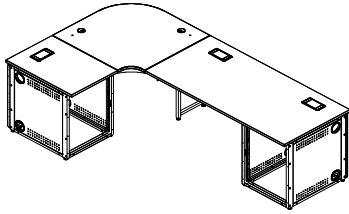

Console #4 (29"H) - 68026		
Qty	Description	Item#
1	29" Radius Corner	68106
1	Triple Worksurface	68202
1	Single Worksurface	68200
2	29" Equipment Rack	68107
2	29" Wall Filler Panel	68101
1	29" Mid-Support Leg	68104

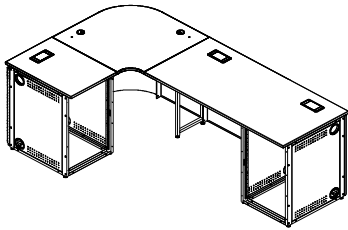
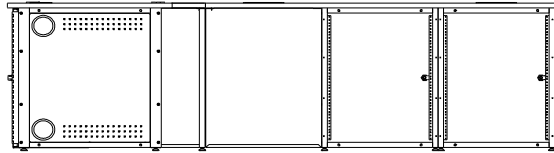
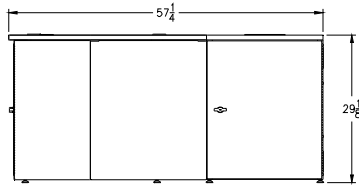
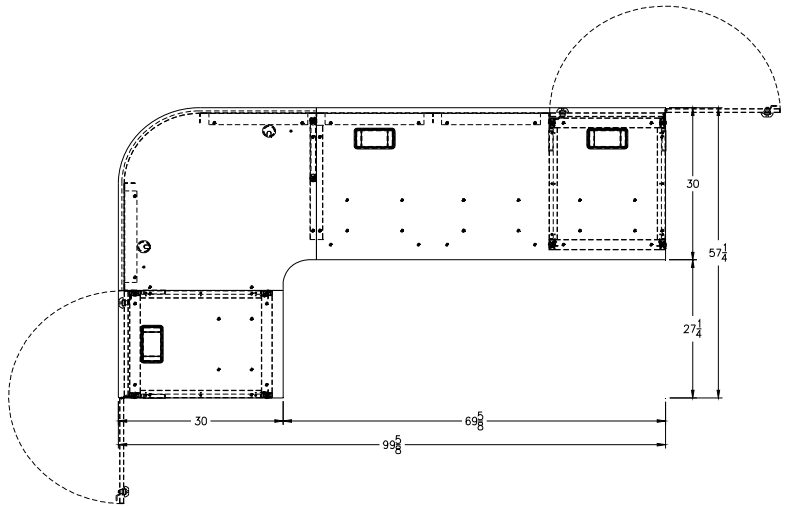

Console #4 (36"H) - 68027		
Qty	Description	Item#
1	36" Radius Corner	68156
1	Triple Worksurface	68202
1	Single Worksurface	68200
2	36" Equipment Rack	68157
2	36" Wall Filler Panel	68151
1	36" Mid-Support Leg	68154

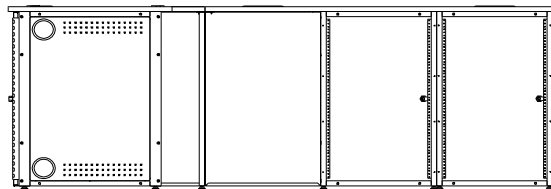
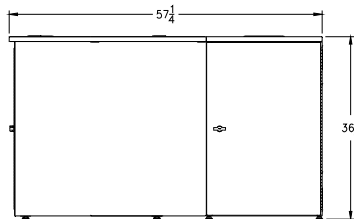
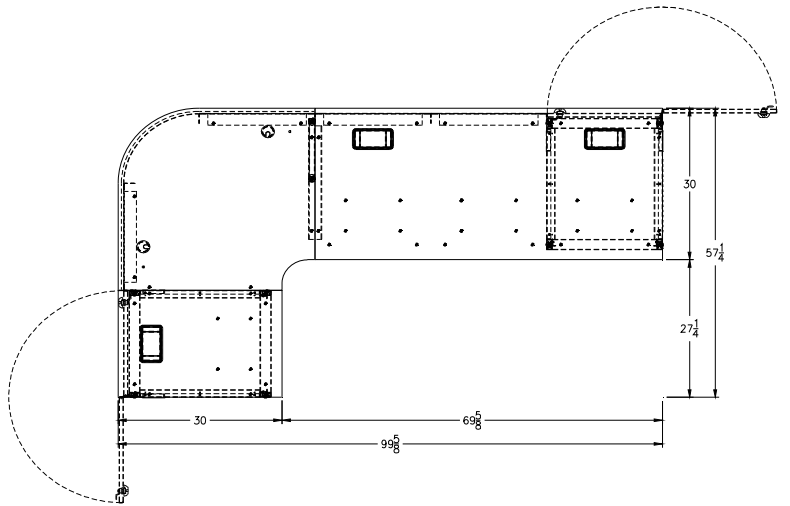

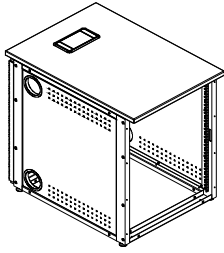

Console #5 (29"H) - 68028		
Qty	Description	Item#
1	Single Worksurface	68200
1	29" Equipment Rack	68107

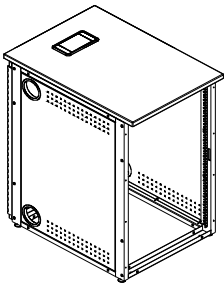
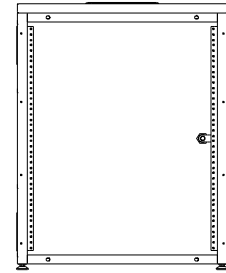
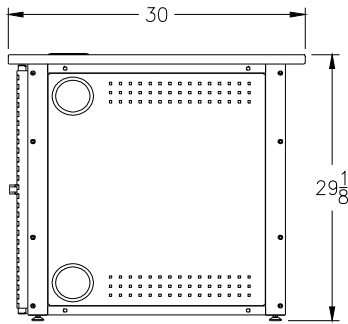
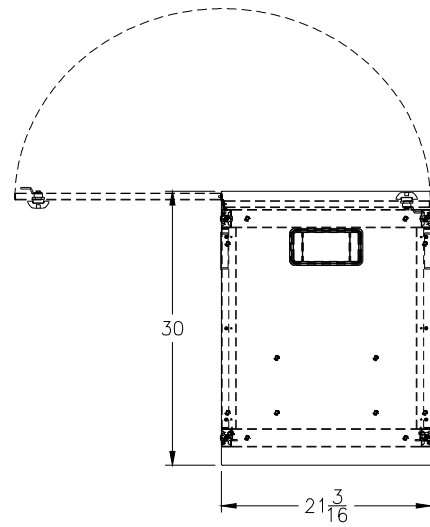

Console #5 (36"H) - 68029		
Qty	Description	Item#
1	Single Worksurface	68200
1	36" Equipment Rack	68157

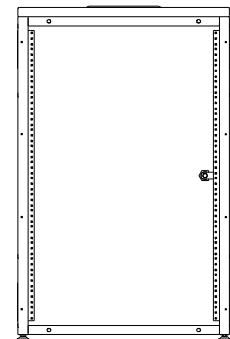
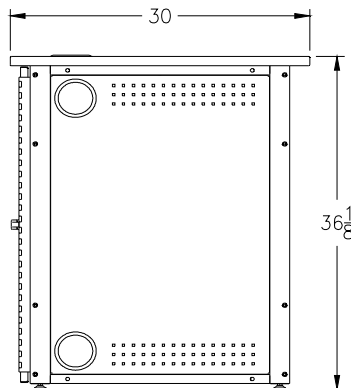
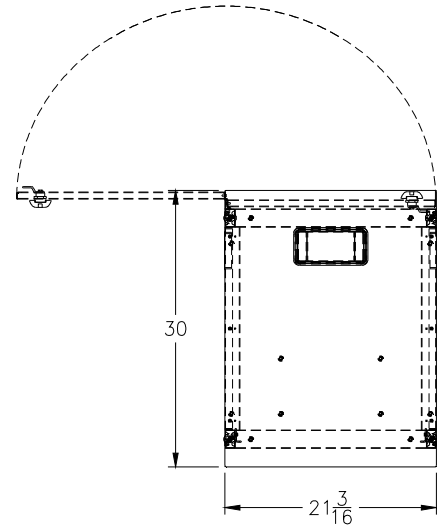

Console #6 - 68030		
Qty	Description	Item#
1	Triple Worksurface	68202
1	Single Worksurface	68200
1	29" Equipment Rack	68107
2	29" Wall Filler Panel	68101
1	36" Equipment Rack	68157
1	Stepped-Height Bracket	68205

